

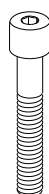

边箱支架安装指南

Installation instruction for the support of side box

散件清单 parts and components list



M8x55

① x2

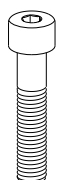

M10x50

② x2

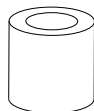

φ14xφ8.5x13.5

③ x2

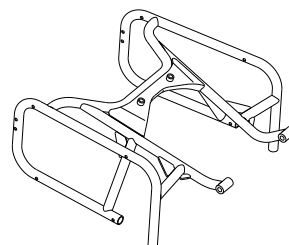

边箱支架
side box support

④ x1

● 该部分零件仅安装铝箱时需要。

The parts below are only needed when installing the Aluminum side box.

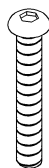

M6x35

⑤ x4



M6x40

⑥ x8



M6锁紧螺母
M6 Locknut

⑦ x12



垫片
Gasket

⑧ x16

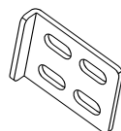

边箱安装锁扣片
Side box mounting clips

⑨ x2

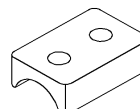

边箱安装锁垫块
Side box mounting pad

⑩ x2



边箱安装衬套
Side box mounting bushing

⑪ x8

步骤一： Step 1:

用6#内六角工具拆下后靠背两颗螺栓。
Remove two bolts from back rest with the 6# inner hexagon socket tool.

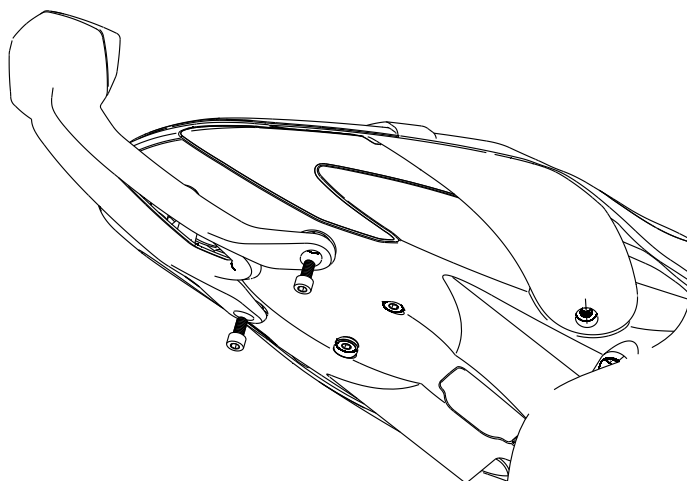

注意attention

1. 安装前请仔细阅读安装说明。

Please read the installation instruction carefully before installation.

2. 定期检查各部件固定螺栓。

Check the fixed bolts on each part periodically.

3. 该支架仅适用于我司官网销售的边箱，其它边箱请谨慎购买，以免不适。

The bracket is only suitable for the side box which is sold by our official website, not suitable for other side boxes, please purchase it carefully to avoid mismatch.

安装示意图
installation chart

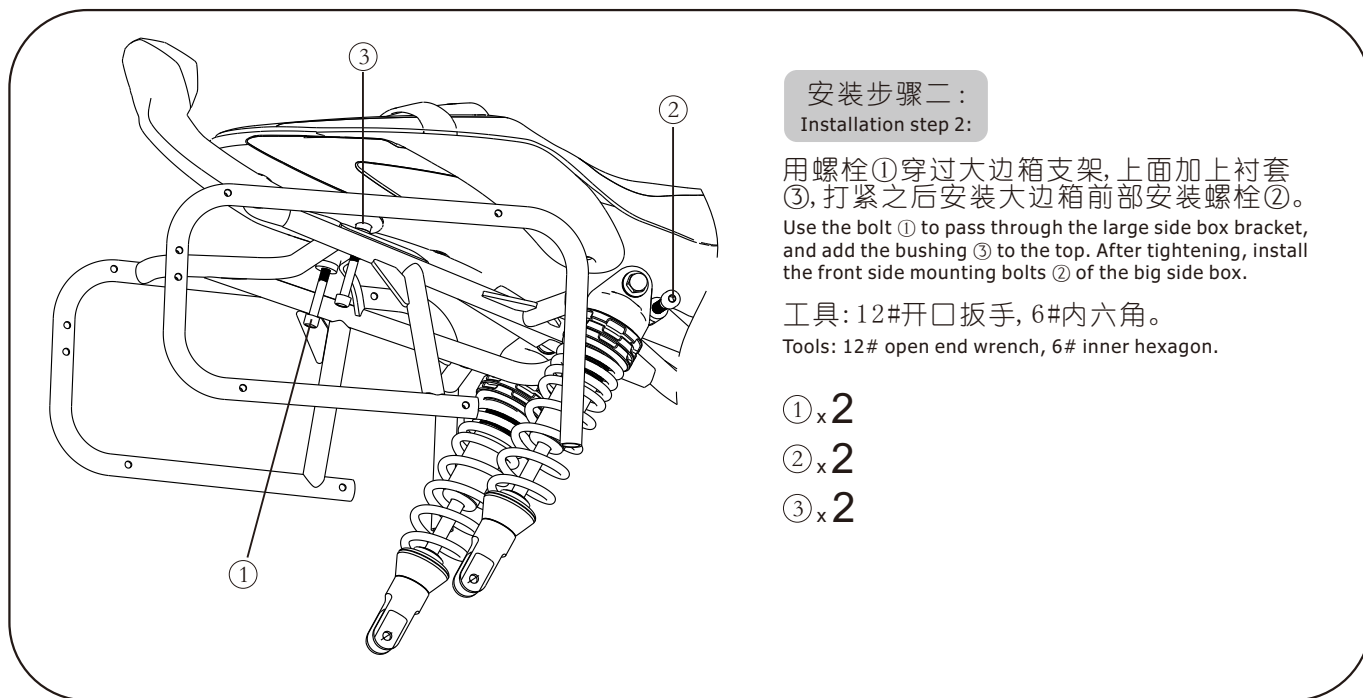

安装步骤二：
Installation step 2:

用螺栓①穿过大边箱支架,上面加上衬套③,打紧之后安装大边箱前部安装螺栓②。
Use the bolt ① to pass through the large side box bracket, and add the bushing ③ to the top. After tightening, install the front side mounting bolts ② of the big side box.

工具: 12#开口扳手, 6#内六角。
Tools: 12# open end wrench, 6# inner hexagon.

- ① x 2
- ② x 2
- ③ x 2

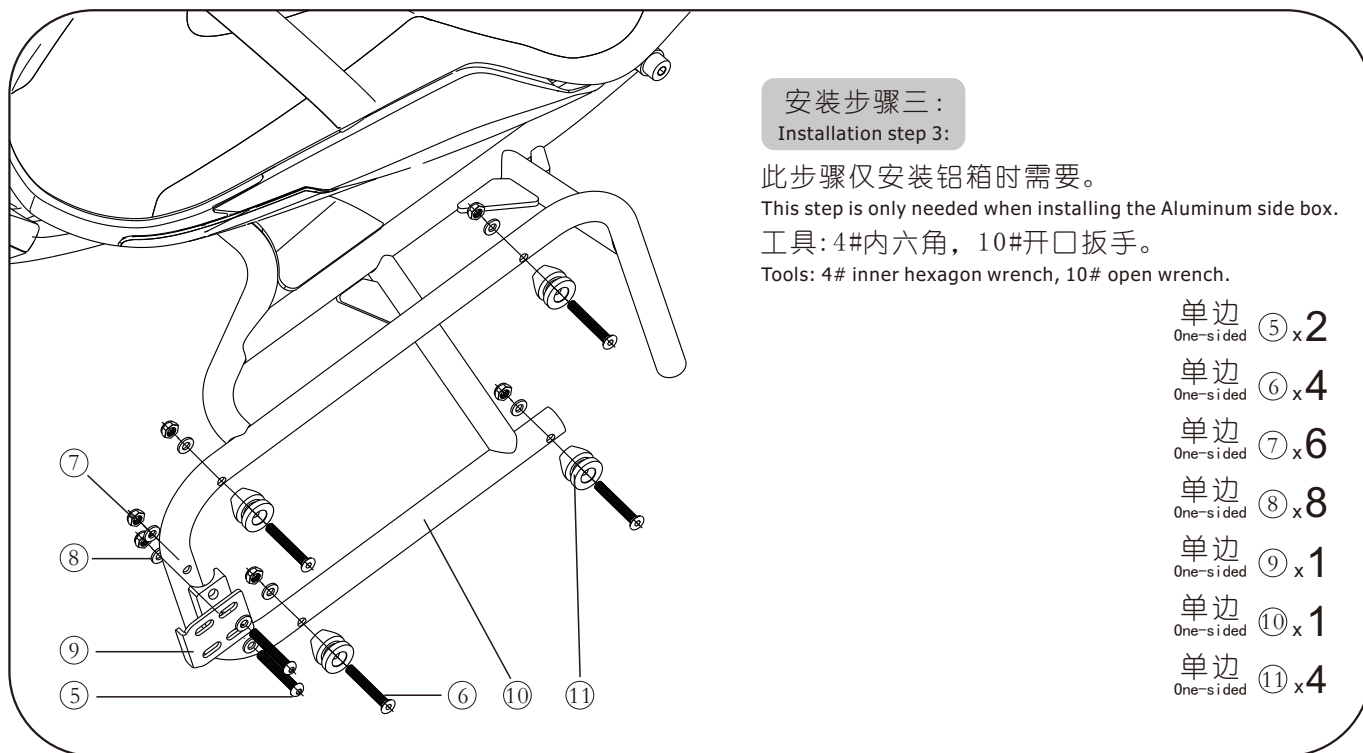

安装步骤三：
Installation step 3:

此步骤仅安装铝箱时需要。
This step is only needed when installing the Aluminum side box.
工具: 4#内六角, 10#开口扳手。
Tools: 4# inner hexagon wrench, 10# open wrench.

- 单边 One-sided ⑤ x 2
- 单边 One-sided ⑥ x 4
- 单边 One-sided ⑦ x 6
- 单边 One-sided ⑧ x 8
- 单边 One-sided ⑨ x 1
- 单边 One-sided ⑩ x 1
- 单边 One-sided ⑪ x 4