

LOBOO L45尾箱安装指南

Tail box installation guide (LOBOO L45)

散件清单 parts and components list

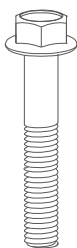

M8x65

①x2

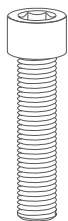

M8x35

②x1

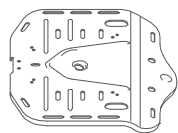

尾箱安装板
tail box mounting plate

③x1



缓冲胶
buffer rubber

④x1

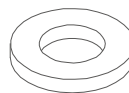

垫片
Gasket

⑤x4

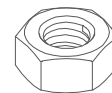

M6锁紧螺母
M6 Locknut

⑥x4

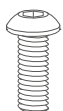

M6x16

⑦x2

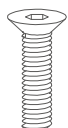

M6x20

⑧x4

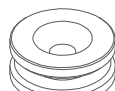

铝葫芦
aluminum hoist

⑨x4



锁扣
lock buckle

⑩x1



GB6187.1 M6螺母
GB6187.1 M6 nut

⑪x2



尾箱
tail box

⑫x1

步骤一： Step 1:

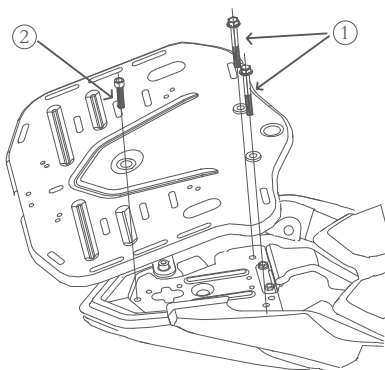
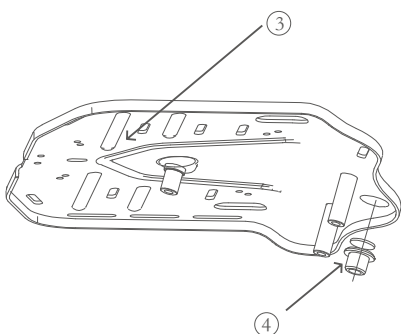

用双面胶把缓冲胶粘到尾箱安装板底部，然后用2颗M8X65和1颗M8X35把尾箱安装板固定在车架上。

Use double-sided tape to glue the buffer adhesive to the bottom of the tail box mounting plate, and then use two M8X65 and one M8X35 to fix the tail box mounting plate to the frame.

推荐工具: 12#套筒扳手 6#内六角扳手
size 12 socket wrench size 6 Allen wrench

①x2

②x1

③x1

④x1

注意attention

1. 安装前请仔细阅读安装说明。

Please read the installation instruction carefully before installation.

2. 定期检查各部件固定螺栓。

Check the fixed bolts on each part periodically.

3. 该尾箱安装板仅适用于我司官网销售的尾箱，其它尾箱请谨慎购买，以免不适。

The tail box mounting plate is only suitable for the tail box which is sold by our official website, not suitable for other tail boxes, please purchase it carefully to avoid mismatch.

安装示意图
installation chart

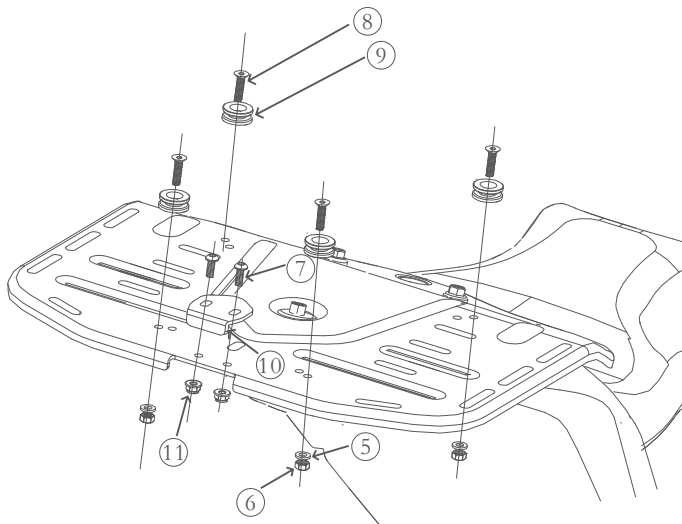

安装步骤二：
Installation step 2:

将铝葫芦和锁扣按图装配在尾箱安装板上。
Assemble the aluminum hoist and lock according to the picture on the tail box mounting plate.

推荐工具：4#内六角，10#开口扳手。
Recommended tools: size 4 inner hexagon size 10 open-end wrench

- ⑤ x 4
- ⑥ x 4
- ⑦ x 2
- ⑧ x 4
- ⑨ x 4
- ⑩ x 1
- ⑪ x 2

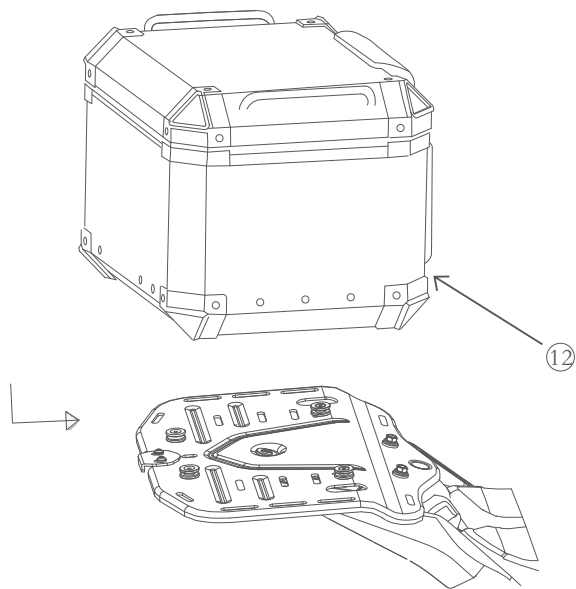

安装步骤三：
Installation step 3:

将萝卜L45尾箱卡入底板，完成安装(安装尾箱前需要将锁扣调整到合适位置)。

Snap the L45 tail box into the bottom plate to complete the installation (you need to adjust the lock to the appropriate position before installing the tail box).

- ⑫ x 1