

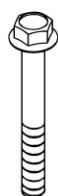

边箱支架安装指南

Installation instruction for the support of side box

散件清单 parts and components list



M8x65

① x 2

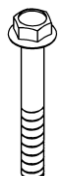

M8x60

② x 2



M8x25

③ x 2

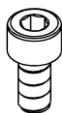

M8x16

④ x 2



M8螺母
M8 Nut

⑤ x 4

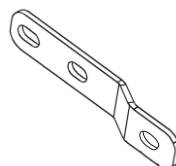

边箱支架脚踏连接板
Footrest connecting board of side box support

⑥ x 2

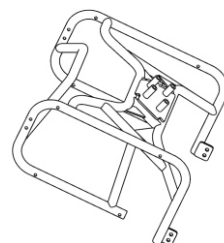

边箱支架
side box support

⑦ x 1

● 该部分零件仅安装铝箱时需要。

The parts below are only needed when installing the Aluminum side box.

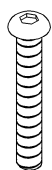

M6x35

⑧ x 4

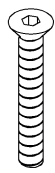

M6x40

⑨ x 8



M6锁紧螺母
M6 Locknut

⑩ x 12

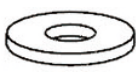

垫片
Gasket

⑪ x 16

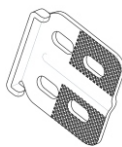

边箱安装锁扣片
Side box mounting clips

⑫ x 2

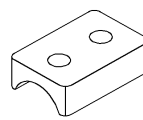

边箱安装锁垫块
Side box mounting pad

⑬ x 2



边箱安装衬套
Side box mounting bushing

⑭ x 8

步骤一： Step 1:

用工具拆下固定后泥板的4颗螺栓。
Remove 4 units bolts off fixed rear mudguard by using tool.

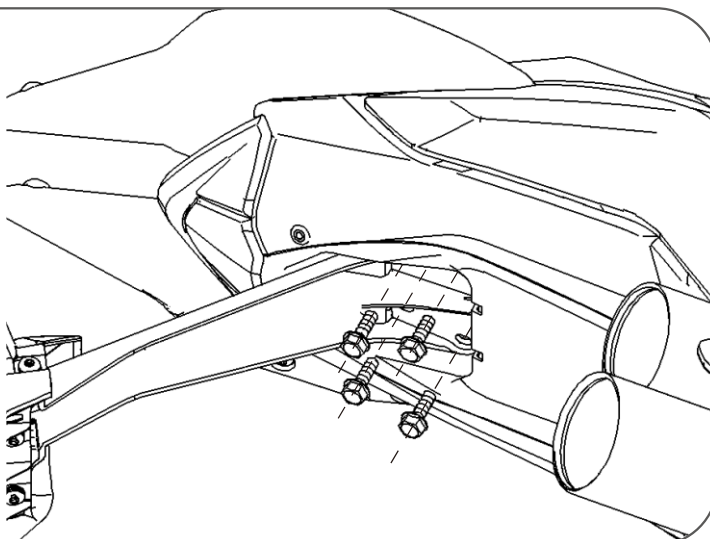

注意attention

1. 安装前请仔细阅读安装说明。

Please read the installation instruction carefully before installation.

2. 定期检查各部件固定螺栓。

Check the fixed bolts on each part periodically.

3. 该支架仅适用于我司官网销售的边箱，其它边箱请谨慎购买，以免不适。

The bracket is only suitable for the side box which is sold by our official website, not suitable for other side boxes, please purchase it carefully to avoid mismatch.

安装示意图
installation chart

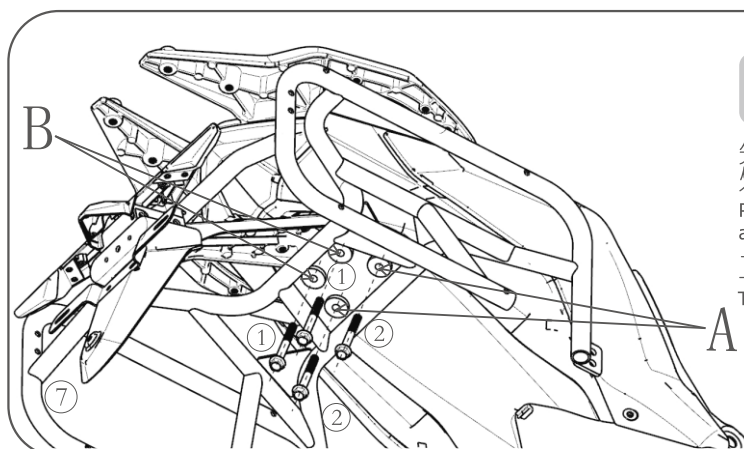

安装步骤二：

Installation step 2:

先预紧A处两个M8X60螺栓，再装配B处两个M8X65螺栓。

Preload the two bolts M8*60 at position A firstly, then assemble the two bolts M8*65 at position B.

工具：棘轮扳手（12#套头）。

Tools: ratchet wrench(12#).

① x 2
② x 2
⑦ x 1

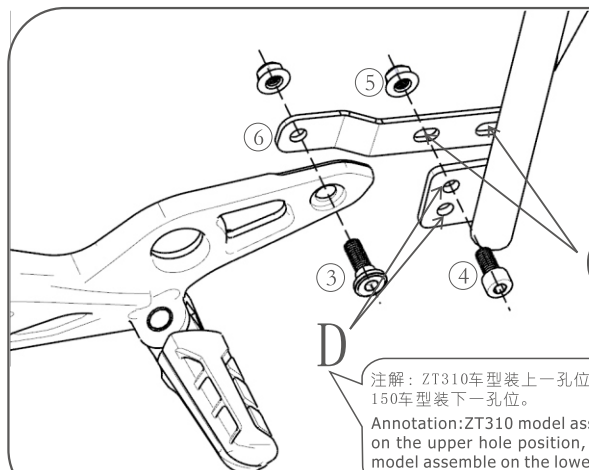

安装步骤三：

Installation step 3:

边箱支架与脚踏连接。

Connect side box support with footrest.

工具：6#内六角，13#扳手。

Tools: 6# inner hexagon wrench, 13# wrench.

注解：ZT310车型装上一孔位，KD150车型装下一孔位。
Annotation: ZT310 model assemble on the upper hole position, KD150 model assemble on the lower one.

注解：ZT310-X/R车型装前一孔位，ZT310-T车型装后一孔位。
Annotation: ZT310-X/R model assemble on the front hole position, ZT310-T model assemble on the rear one.

单边 ③ x 1
One-sided
单边 ④ x 1
One-sided
单边 ⑤ x 2
One-sided
单边 ⑥ x 1
One-sided

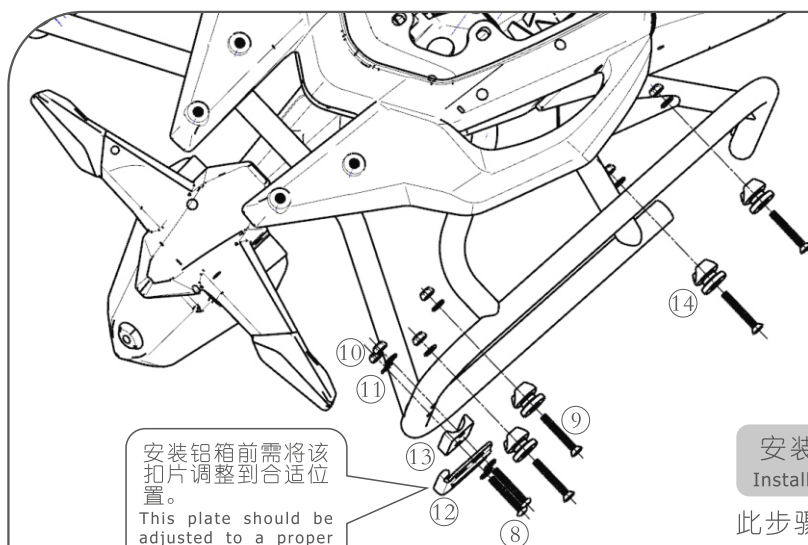

安装铝箱前需将该扣片调整到合适位置。
This plate should be adjusted to a proper position before installing the Aluminum side box.

安装步骤四：

Installation step 4:

此步骤仅安装铝箱时需要。

This step is only needed when installing the Aluminum side box.

工具：4#内六角，10#开口扳手。

Tools: 4# inner hexagon wrench, 10# open wrench.

单边 ⑧ x 2
One-sided
单边 ⑨ x 4
One-sided
单边 ⑩ x 6
One-sided
单边 ⑪ x 8
One-sided
单边 ⑫ x 1
One-sided
单边 ⑬ x 1
One-sided
单边 ⑭ x 4
One-sided